



HOW TO MAKE A PINWHEEL:

RELATED: [Fast and Frugal Patriotic Wreath](#), [Tin Can Stilts Classic Toy Tutorial](#)



1. Print your papers by clicking on the download button below. (You'll get access to printables in large and small sizes.)



2. Cut out the squares from the printable papers, and cut along the black interior lines to form almost-triangles. (Note that the lines do not go all the way to the center of the pinwheel. You are only cutting part way.)
3. Bend every other corner into the center of the pinwheel (overlap the center x slightly).

4. Release the corners. Using a thumbtack, poke a hole in the center of the pinwheel (through the x) and in every corner that you folded. I found it easiest to poke through the paper and into a pin cushion.

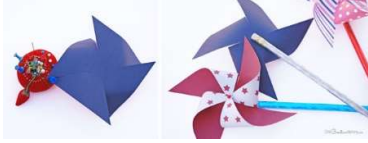

5. Insert a pin into all four corner holes and then into the center hole. Push the pin into the side of a pencil eraser. (You can use the thumbtack instead of a pin. The thumbtack creates a larger hole than the pin, so if you use the pin, the wheel will spin more easily since it's smaller than hole you created.)
6. Choose a center circle from my patterns to glue over the pin, or use the pinwheel as is. Have fun!